

\*Applicable to all Vista Panel shapes

## PACK INCLUDES

### MATRIX BAFFLES (1 of purchased shape)

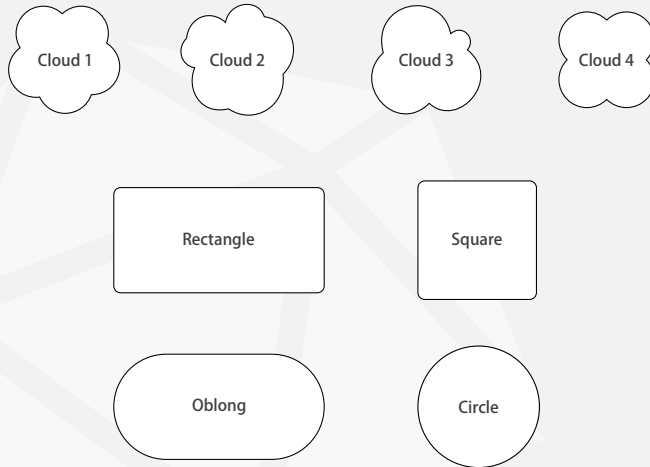

### CEILING STENCIL

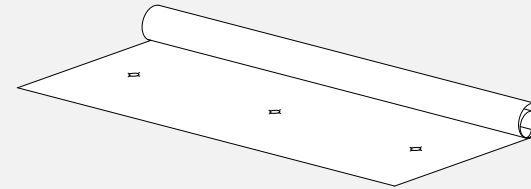

### SCREWS

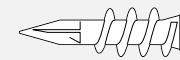
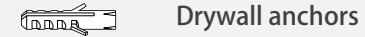
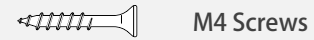

### SUSPENDED FIX

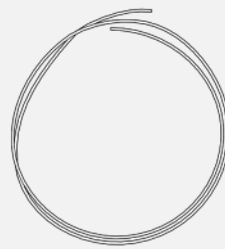

WIRE  
1200 mm standard

### NOT INCLUDED

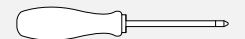

Phillips



Pencil



Laser



Measuring tape



2 x person  
assembly  
recommended



2 x ladder  
recommended

\*Applicable to all Vista Panel shapes

## LASER METHOD 1.

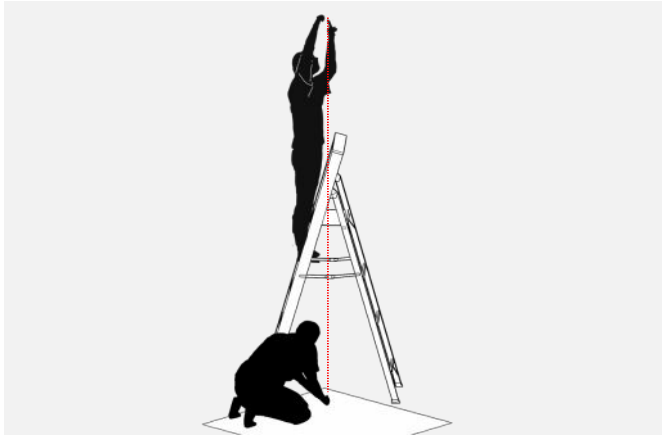

Lay supplied stencil on ground directly below ceiling surface you would like to install your Vista panel.  
Point laser vertically on each marked spot on the stencil while the second person marks the laser spots on the ceiling using a ladder. Apply this method to each attachment spot.

## MANUAL METHOD 1.



Hold stencil to ceiling, marking all fitment locations on ceiling.  
If unable to use stencil, use measurements marked on stencil and manually measure and transfer markings.

## 2.

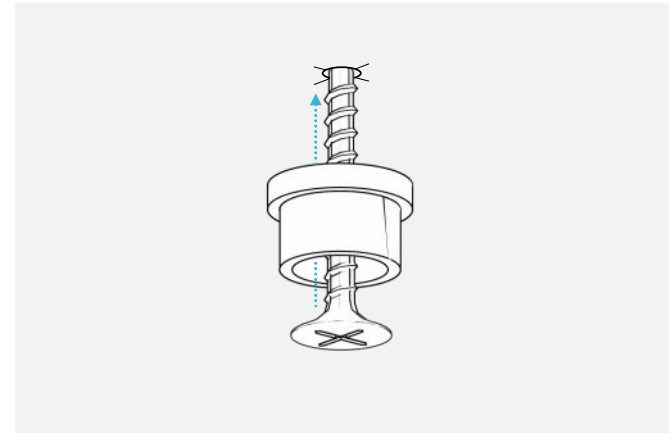

Insert supplied screws\* into adjustment 1 and screw into ceiling at marked spots.

\*Use appropriate anchor depending on ceiling material.

\*Applicable to all Vista Panel shapes

## 1.

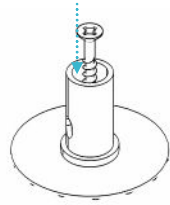

Screw adjustment 4 to base, rear of panel, until fixed tightly.

## 1.A.

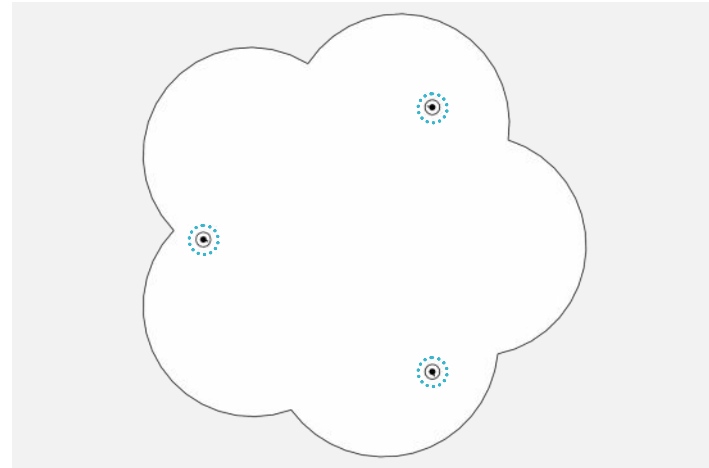

Apply this to all fitment spots.

## 2.

**Tip!**  
To extend, pull metal  
gizmo with finger  
nail to release wire

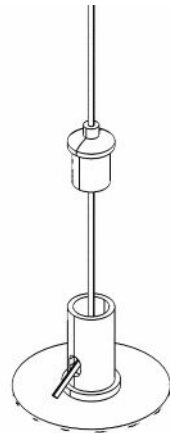
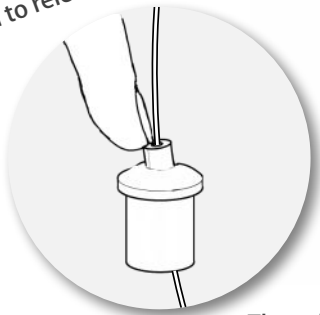

Thread wire a few inches through Adjustment 3. Insert wire through adjustment 4. Screw both adjustments till tight.

## 2.A.

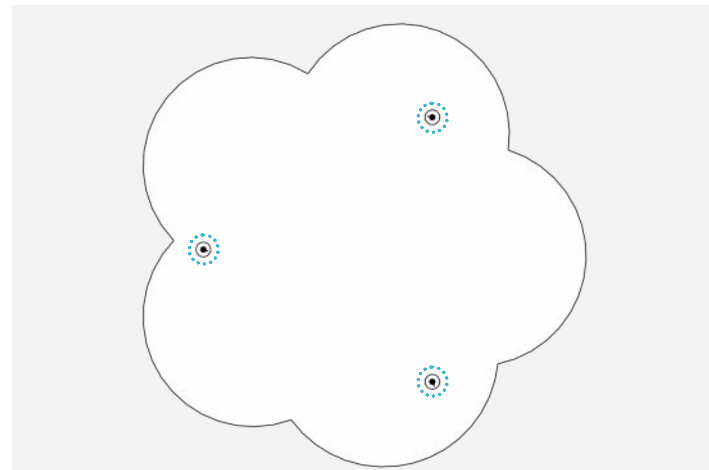

Apply this to all fitment spots.  
Adjust all wires to the desired height using accurate measuring\*

\*Recommended  
distance from  
ceiling: 250mm

\*Applicable to all Vista Panel shapes

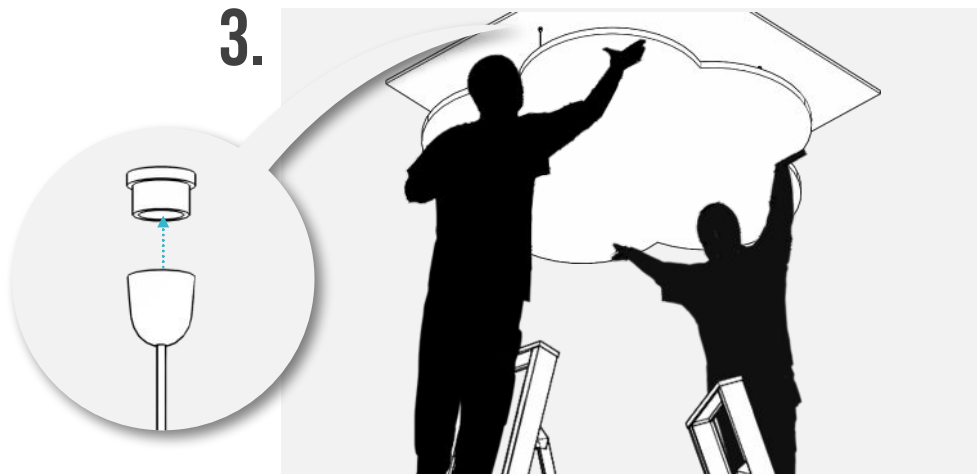

Using responsible safety measures, lift to designated spot using two people.  
Screw all of adjustment 2 into all of adjustment 1 to ceiling.  
Attach opposite corners first then move on to the rest.

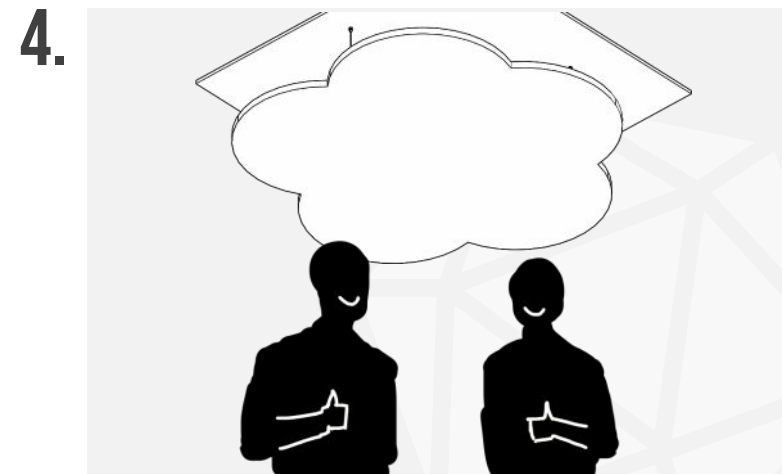

Adjust wire length if needed. Enjoy your finished Vista Panel