

# Harakeke Acoustic Desk Art

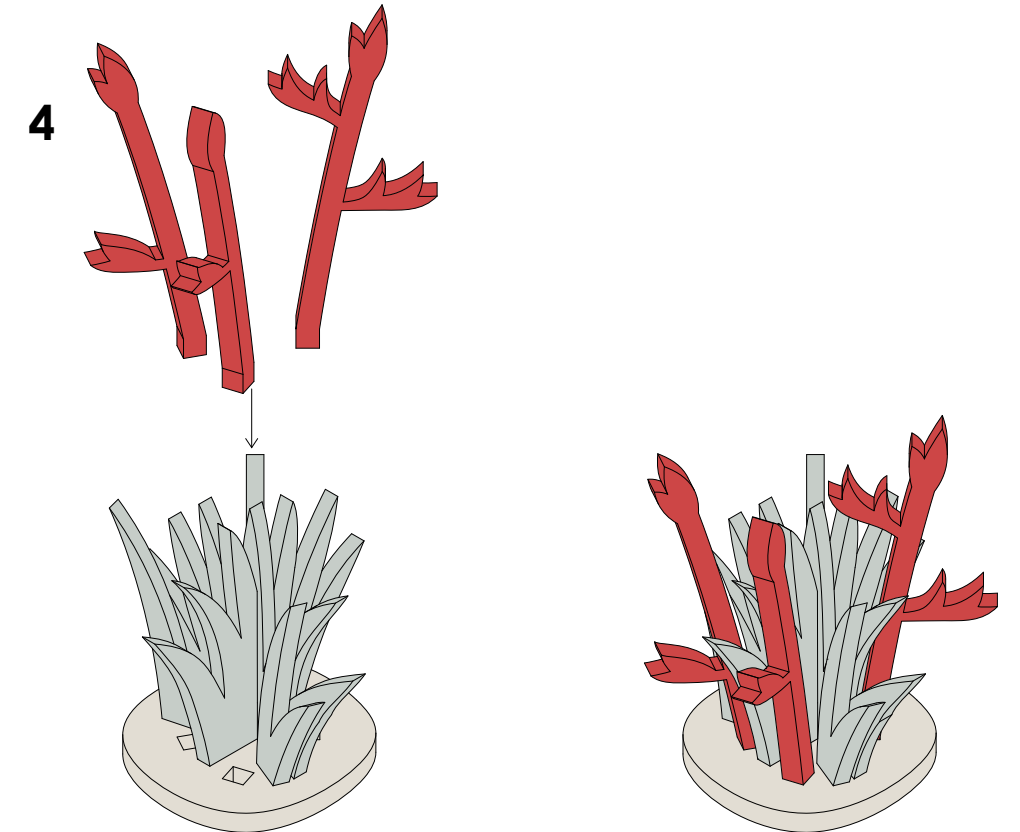

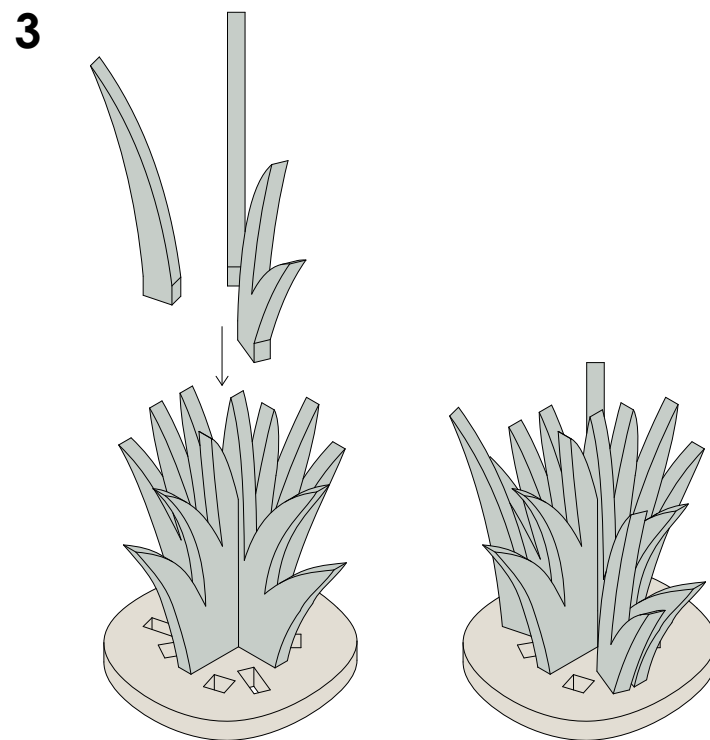
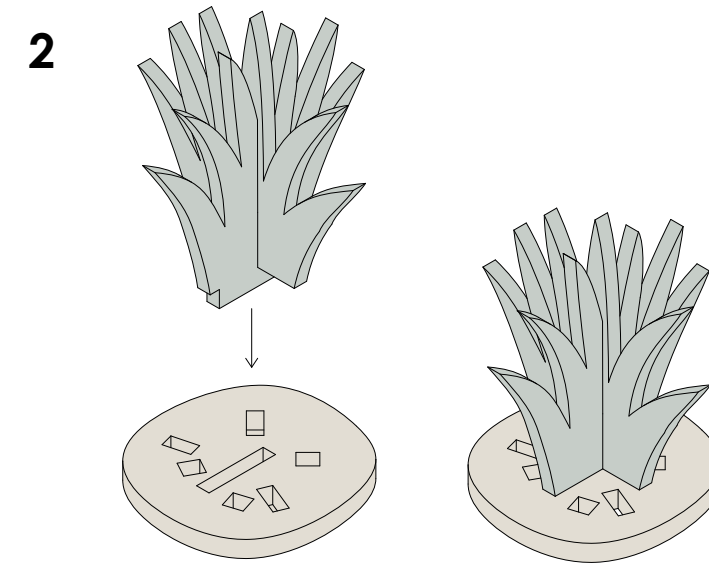
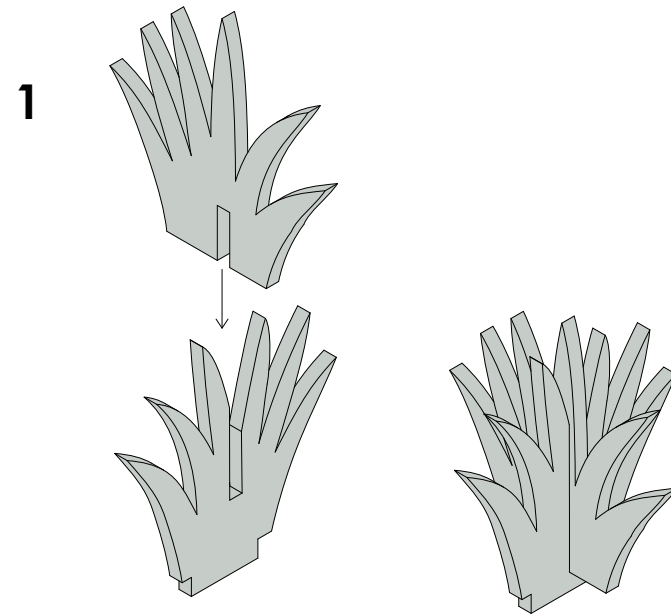
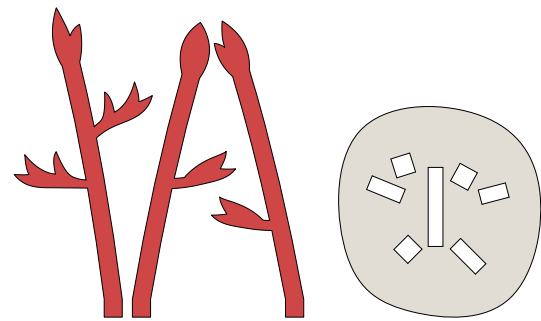
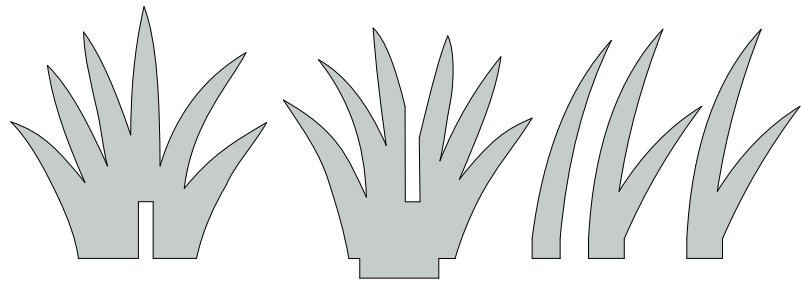
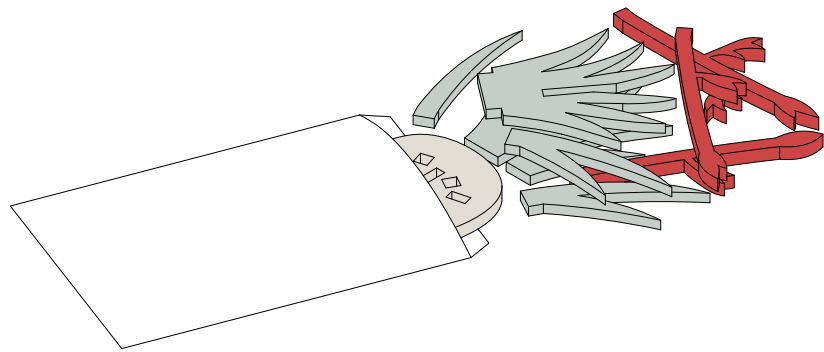
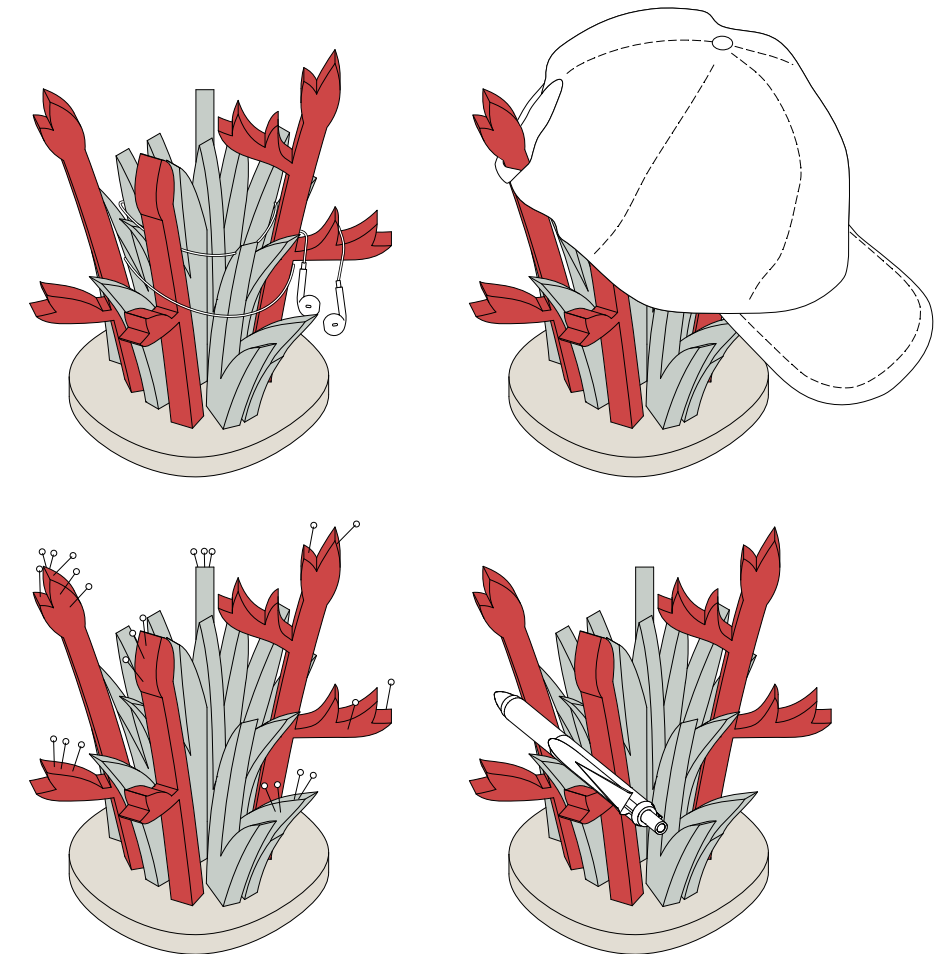

## Sustainability

Harakeke and Wharariki, New Zealand's native flax, hold cultural significance as a material used not only for weaving, but as a representation of Whānau.

Renewability and sustainability can be found in the practices and cultivation of Harakeke, something that we at db sorb take into account and incorporate into our own practices.

With our no-glue systems of install, our products eliminate toxic adhesives and high energy aluminum. Our mounting systems facilitate both clean installation and disassembly, allowing the reusability and recyclability of our products.

**#dbHarakeke**

We would love to see how you use  
your desk harakeke  
Post a picture on Instagram & tag us !

